

REVISIONS				
ZONE	REV.	DESCRIPTION	DATE	APPROVED

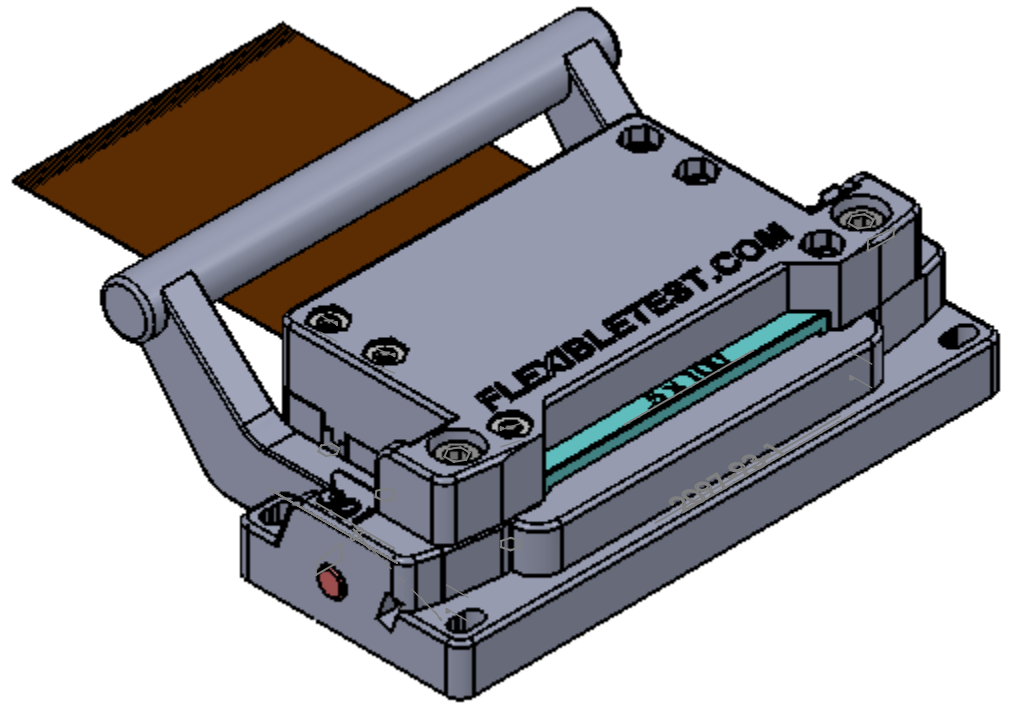

MAXIMUM FLEX WIDTH IS .5mm X 100 TRACES. TEST EQUIPMENT FLEX LENGTH COMES IN TWO STANDARD LENGTHS - 102mm AND 76mm. PLEASE SPECIFY. LONGER LENGTHS ARE CONSIDERED CUSTOM

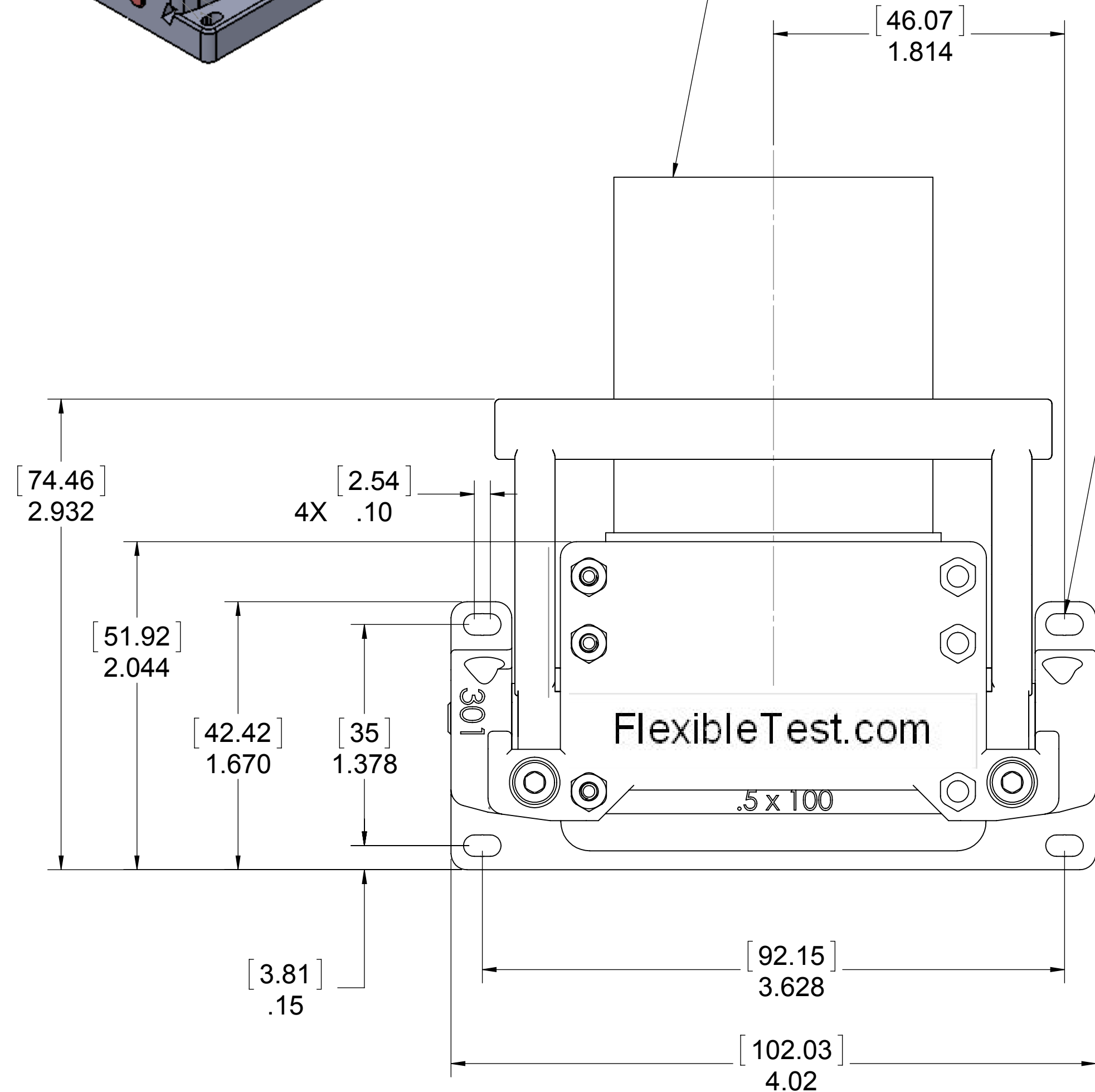

4X CLEARANCE FOR M3 OR 4-40 SCREW

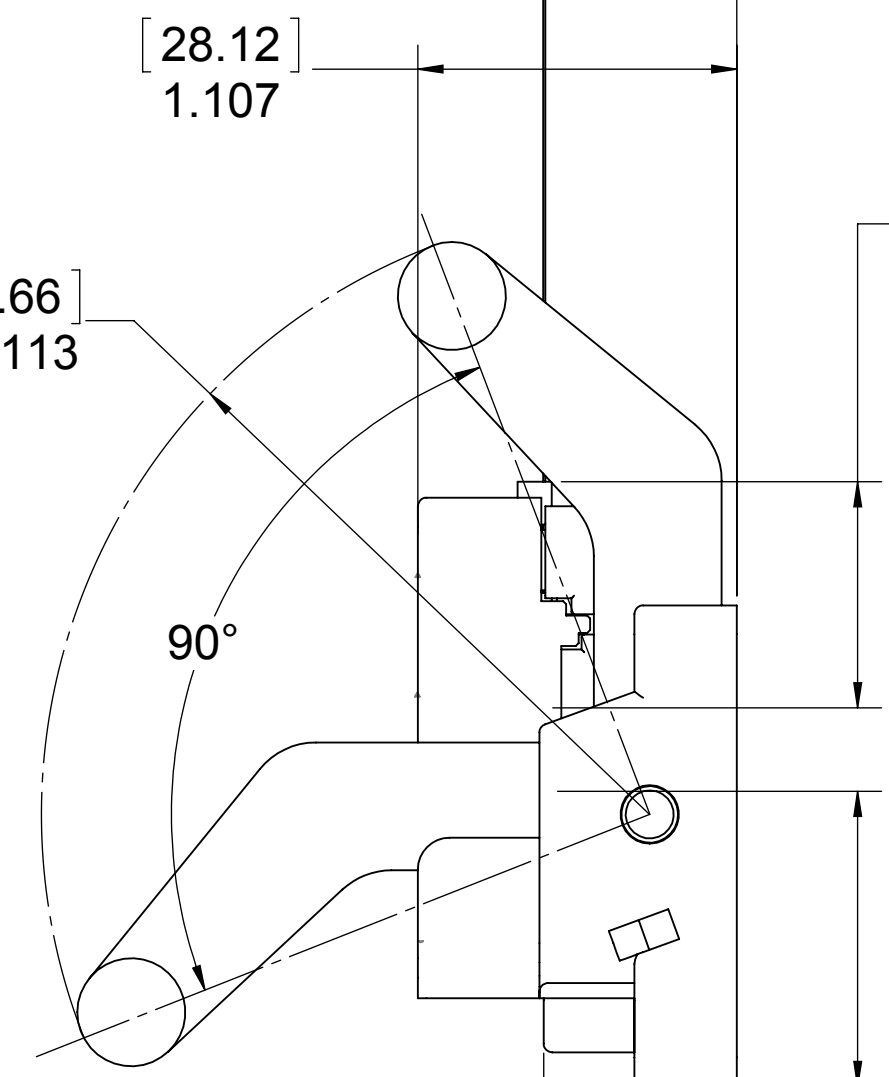

NOTE: FOR THIS UNIT TRACES ON DUT (UUT) FLEX MUST BE FACING DOWN. TRACES ON FLEX GOING TO TEST EQUIPMENT ARE ALSO DOWN, BUT CAN BE MADE TO FACE UP IF A FLIPOVER FLEX IS USED.

www.flexibletest.com

VIEWS ARE GENERATED BY THIRD ANGLE PROJECTION

PROPRIETARY AND CONFIDENTIAL THE INFORMATION CONTAINED IN THIS DRAWING IS THE SOLE PROPERTY OF Z-AXIS CONNECTOR CO. ANY REPRODUCTION IN PART OR AS A WHOLE WITHOUT THE WRITTEN PERMISSION OF Z-AXIS CONNECTOR CO. IS PROHIBITED.

UNLESS OTHERWISE SPECIFIED:		NAME	DATE	Z-AXIS CONNECTOR CO.
DIMENSIONS ARE IN INCHES		RCK	9/6/17	
TOLERANCES:		CHECKED		TITLE: ORIGINAL DOWN MEDIUM FFC
FRACTIONAL ± 1/32		ENG APPR.		
ANGULAR: MACH ± 1/2°		MFG APPR.		SIZE DWG. NO. REV C ODM-2D-F-A
TWO PLACE DECIMAL ± 0.010		Q.A.		
THREE PLACE DECIMAL ± 0.005		COMMENTS:		SCALE: 1:1 WEIGHT: SHEET 1 OF 1
FOUR PLACE DECIMAL ± 0.0002				
INTERPRET GEOMETRIC TOLERANCING PER:				
MATERIAL:				
FINISH:				
NEXT ASSY	USED ON			
APPLICATION		DO NOT SCALE DRAWING		